

AYERS PRESERVE

Directions:

- * Follow Route 82 south.
- * Take a left onto Hopyard Road.
- * Access is from Hopyard Road via a narrow finger of the property 1/4 mile south of Dolbia Hill Road and 3/4 miles north of Route 82.

IMPORTANT: Parking is very limited and will have limited sightlines so exercise extreme caution.

NOTE: Directly across the Eightmile River from the Ayers Preserve, the Nature Conservancy (TNC) holds an easement that abuts the TNC's Burnham Brook Preserve.

For more information or to report any problems during your visit, see:

www.ehlt.org

Trail Facts:

- The blue blazed loop trail is .3 miles long.
- The trail starts at the road and leads you down to the Eightmile River.
- The 300 feet on the opposite side of the river is Nature Conservancy protected land.
- The terrain is flat.

NOTE: The section along the Eightmile River can be very wet, depending on recent rainfall. Spring floods will periodically inundate the entire preserve.

Permitted Activities:

- ◆ Hiking
- ◆ Nature study
- ◆ Fishing
- ◆ Snowshoeing
- ◆ Mountain biking
- ◆ Horseback riding
- ◆ Birding

No motorized vehicles allowed on the property.

EAST HADDAM TRAILS

AYERS PRESERVE

The 6-acre Ayers Preserve was donated to the East Haddam Land Trust in 2002. About 300 feet borders the Eightmile River and is floodplain. Due to scarring of the lands by floods, groundcover near the river is sparse. The site was once a pasture and meadow and had been planted as a Christmas tree farm. Now, the spruce trees are large, eliminating sun in the understory. Naked spruce limbs now intertwine below a lush canopy of green spruce branches. The area is dotted with red maples, grape vines, and bittersweet vines and the grounds are covered with large colonies of royal, cinnamon, and New York ferns. Cultivated species of trees and shrubs border the property.



EAST HADDAM
YOUTH AND FAMILY
SERVICES



AYERS PRESERVE

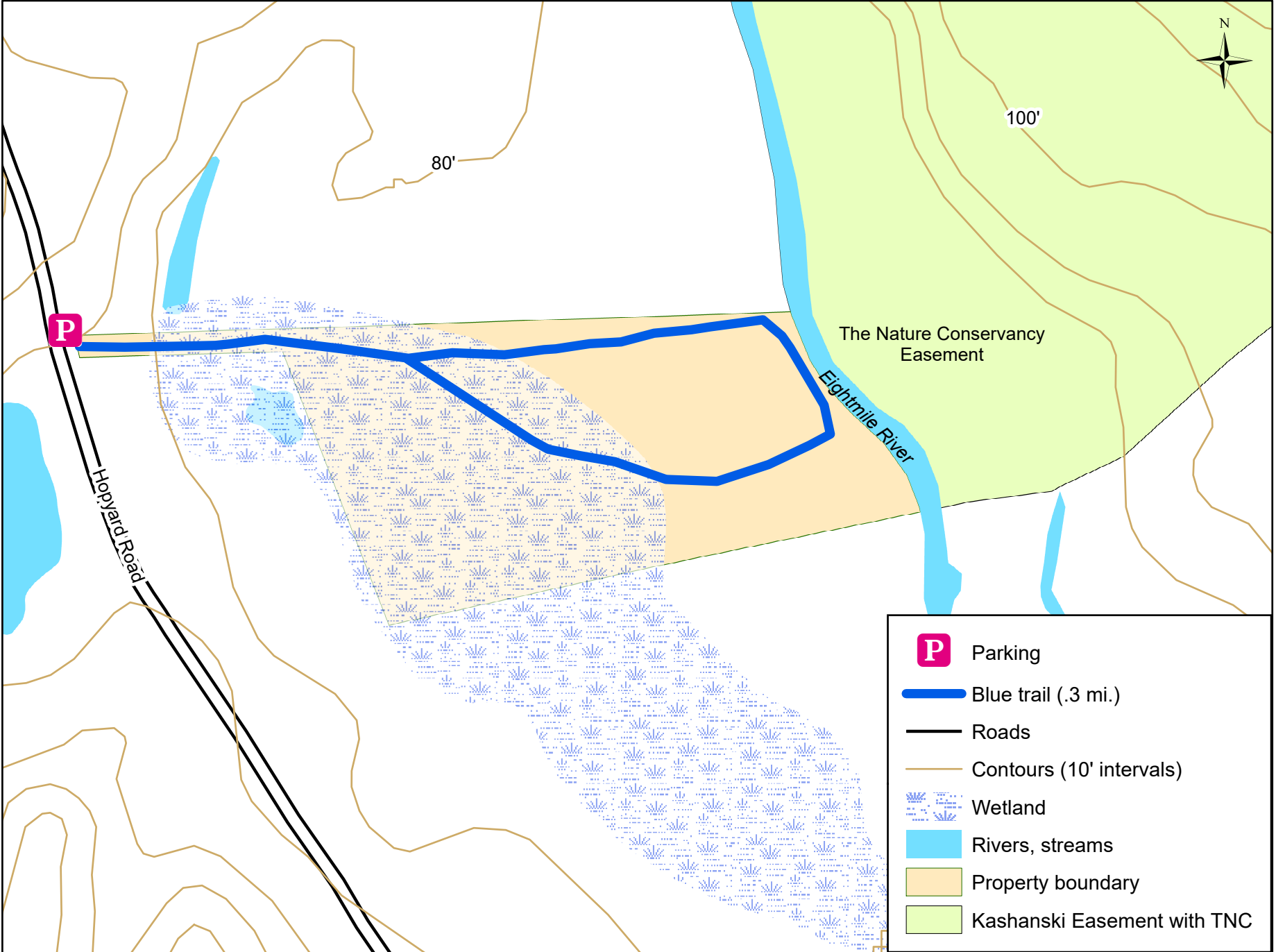

For general reference only

- Parking
- Blue trail (.3 mi.)
- Roads
- Contours (10' intervals)
- Wetland
- Rivers, streams
- Property boundary
- Kashanski Easement with TNC

Managed by EAST HADDAM LAND TRUST

